

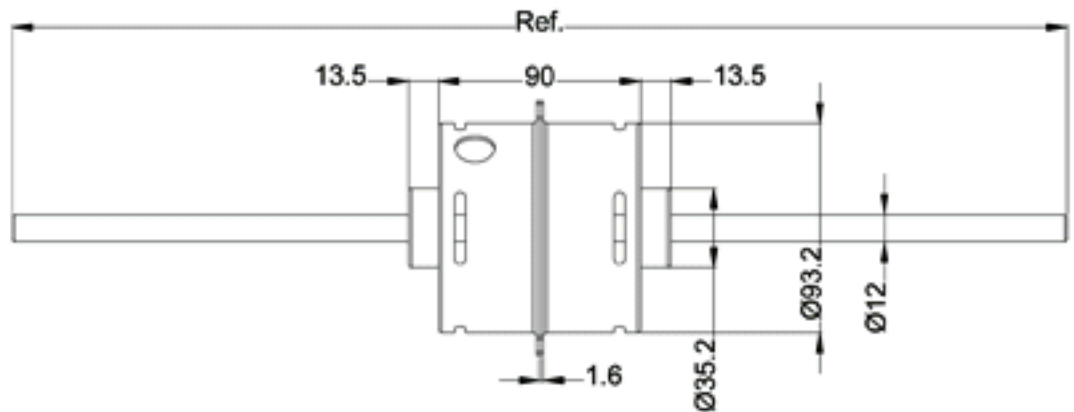

**JGB03**



## SPECIFICATIONS

RATE OUTPUT	RATE SPEED	RATE TORQUE	RATE INPUT CURRENT
92W	1150 RPM	7.8 KG-CM	0.93 A
VOLTAGE	MAX INPUT CURRENT	SPEED CONTROL RANGE	
220 VAC	3A	580 ~ 1200 RPM	