



# NESSCAP® Ultracapacitor Products

## Features

- EDLC (Electric Double Layer Capacitor)
- Weldable terminals
- Ultra low internal resistance
- Highest power performance available



## Product & Spec.

Rated Capacitance (F)	Internal Resistance (mΩ)		Max. Current (A)	Leakage Current (mA)	Stored Energy (Wh)	Specific Energy (Wh/kg)	Nominal Weight (g)	Part Number
	AC(100Hz)	DC						
Discharge with constant current at 25°C			1 sec discharge rate to 1/2V <sub>R</sub>	72hours, 25°C	at V <sub>R</sub>	Gravimetric		
650	< 0.50	< 0.60	610	< 1.50	0.658	3.21	205	ESHSR-0650C0-002R7A5
1200	< 0.40	< 0.48	1,000	< 2.70	1.215	4.34	280	ESHSR-1200C0-002R7A5
1600	< 0.34	< 0.41	1,270	< 3.00	1.620	4.84	335	ESHSR-1600C0-002R7A5
2000	< 0.28	< 0.33	1,580	< 4.20	2.025	5.19	390	ESHSR-2000C0-002R7A5
3000	< 0.22	< 0.26	2,210	< 5.20	3.038	5.73	530	ESHSR-3000C0-002R7A5

Rated Voltage, V <sub>R</sub>	2.7 V	
Surge Voltage	2.85 V	
Capacitance Tolerance	0% / +20%	
Operating Temperature Range	-40 ~ 65 °C	ΔCAP  < 5% and ΔESR < 150% of initial value measured at 25°C
Storage Temperature Range	-40 ~ 70 °C	
Life Time at RT <sup>(1)</sup>	10 years	(1)  ΔCAP  < 30% and ΔESR < 150% of specified value, respectively and LC < specified value
Cycle Life (25°C) <sup>(1)(2)</sup>	1,000,000 cycles	(2) Cycled between rated voltage and half rated voltage under constant current at 25°C

\* Life time is provisional value

© NESSCAP 2010. All Rights reserved. Design Specifications are subjected to change without notice.

Taiwan Agent : Component Plus Inc.

Contact person : Ray Jeng, Mobile : +886-916-205145

Tel: +886-2-2898-4050 Fax: +886-2-2896-9157 e-mail: ray.jeng@seed.net.tw

ISO 9001, ISO 14001, TS 16949



## Dimensions

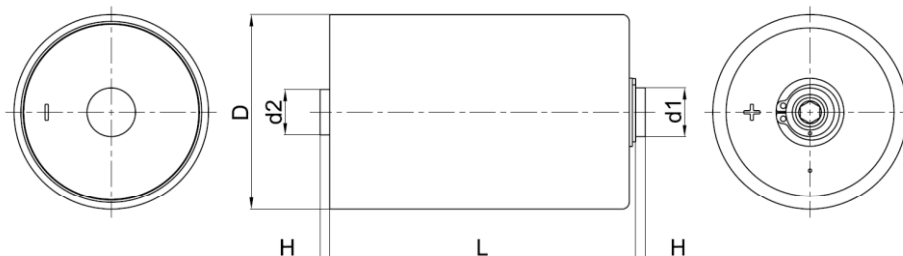

Part Number	Capacitance (F)	Dimension (mm)				
		D ( $\pm 0.2$ )	L ( $\pm 0.3$ )	H ( $\pm 0.125$ )	d1 (0/-0.05)	d2 (0/-0.05)
ESHSR-0650C0-002R7A5	650	60.2	51.5	3.0	14.9	14.0
ESHSR-1200C0-002R7A5	1200	60.2	74.0	3.0	14.9	14.0
ESHSR-1600C0-002R7A5	1600	60.2	85.0	3.0	14.9	14.0
ESHSR-2000C0-002R7A5	2000	60.2	102.0	3.0	14.9	14.0
ESHSR-3000C0-002R7A5	3000	60.2	138.0	3.0	14.9	14.0