

氣動式不鏽鋼閘刀閥

PNEUMATIC TYPE STAINLESS KNIFE GATE VALVE

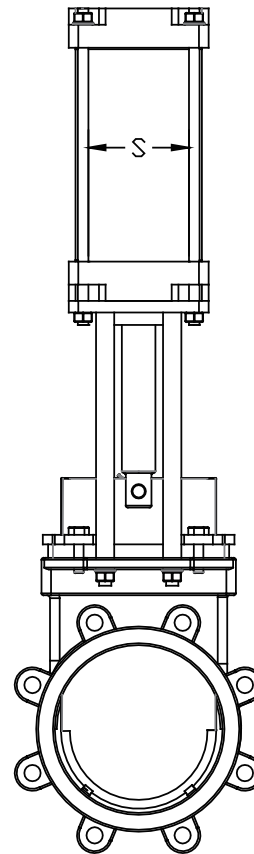

連接規格: (FLANGE)
JIS 5K JIS 10K JIS 7.5K
ANSI 150#
DIN PN10 PN16

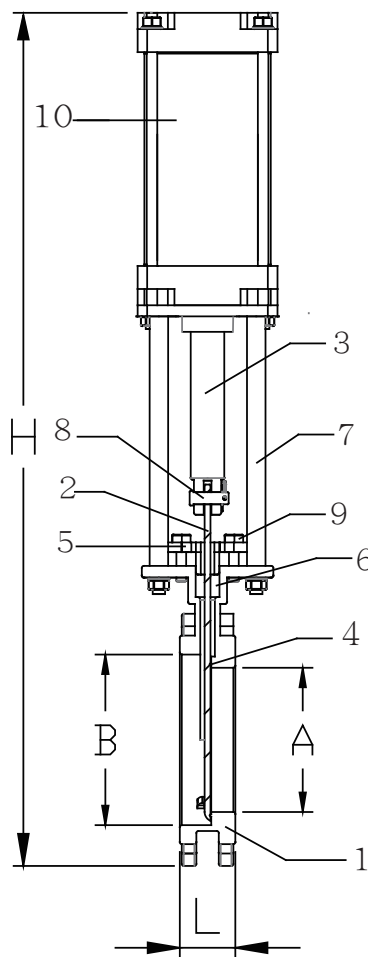

DIMENSION: MM

SIZE	L	A	B	S	H
2"	48	42	64	63	520
2-1/2"	51	57	80	63	570
3"	51	72	95	80	630
4"	51	97	122	80	690
5"	57	125	148	125	870
6"	57	144	166	125	890
8"	70	195	222	150	1100
10"	70	245	272	180	1500
12"	76	306	306	200	1600
14"	76	350	375	250	1860
16"	89	400	430	250	2070
18"	89	435	475	250	2200
20"	114	480	515	300	2400
24"	114	580	620	300	2750

(FOR REFERENCE ONLY.)

MATERIALS

NO.	SUBJECT	MATERIAL
10	ACTUATOR	ALLOY FC
9	BOLT	SUS304 SUS316
8	CONNECTOR	SUS304 SUS316
7	YOKE	DUCTILE IRON
6	GLAND PACKING	ASB NON-ASB
5	GLAND	SUS304 SUS316
4	SEAT	TEFLON
3	STEM	SS41+HCr
2	PLATE	SUS304 SUS316
1	BODY	SUS304 SUS316
NO.	SUBJECT	MATERIAL

(FOR REFERENCE ONLY.)

MSS-SP81 TEST STANDARD:
BODY TEST: 11kg/cm²(WATER)
SEAT TEST: 2.8kg/cm²(WATER)
LEAKAGE: 4 cc/per in. min.

公司地址: 桃園縣楊梅市楊湖路一段676巷109號
電話: 03-4750919 傳真: 03-4750759
email: valve.ks@gmail.com
統一編號: 89712018